

UltraMint Pro

All-round Ultrasonic Scaler
Scaling | Periodontic | Endodontic



Wide Frequency Range

100% compatible with EMS Type Tips

Autoclavable Case

Intelligent Negative Feedback

In accordance to different tooth surfaces, it will automatically adjust pattern to the tip, offering a stable and sustained scaling treatment that is comfortable and painless for the patient



Sine Wave Drive

Stabilized current output, reducing instantaneous stimulation, to allow comfortable & painless treatment



900ml liquid container, can work directly with sodium hypochlorite, chlorhexidine, hydrogen peroxide and saline



Internal Self-cleaning



Detachable and autoclavable handpiece holder, Resist cross-infection

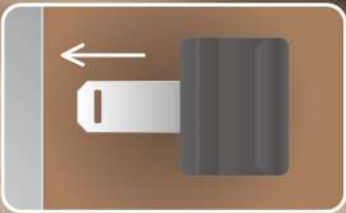

Smart Touch Panel
hassle-free usage even with screen protector film, gloves or water

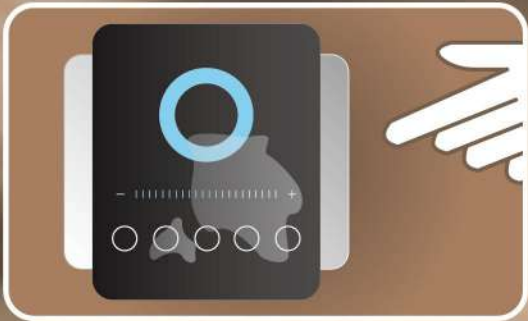

Smart Touch Panel
hassle-free usage even with screen protector film, gloves or water

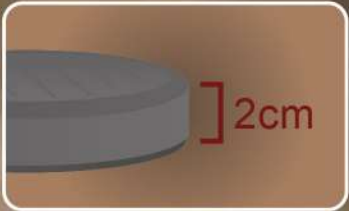

Foot Switch
Less than 2cm height, making foot-control comfortable foot woking experience

Manage Flow Control Directly by Handpiece

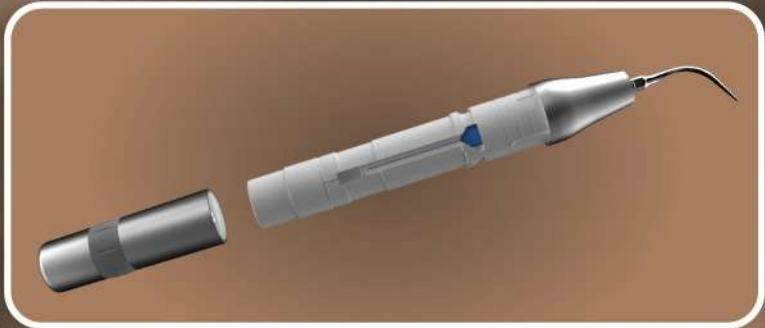
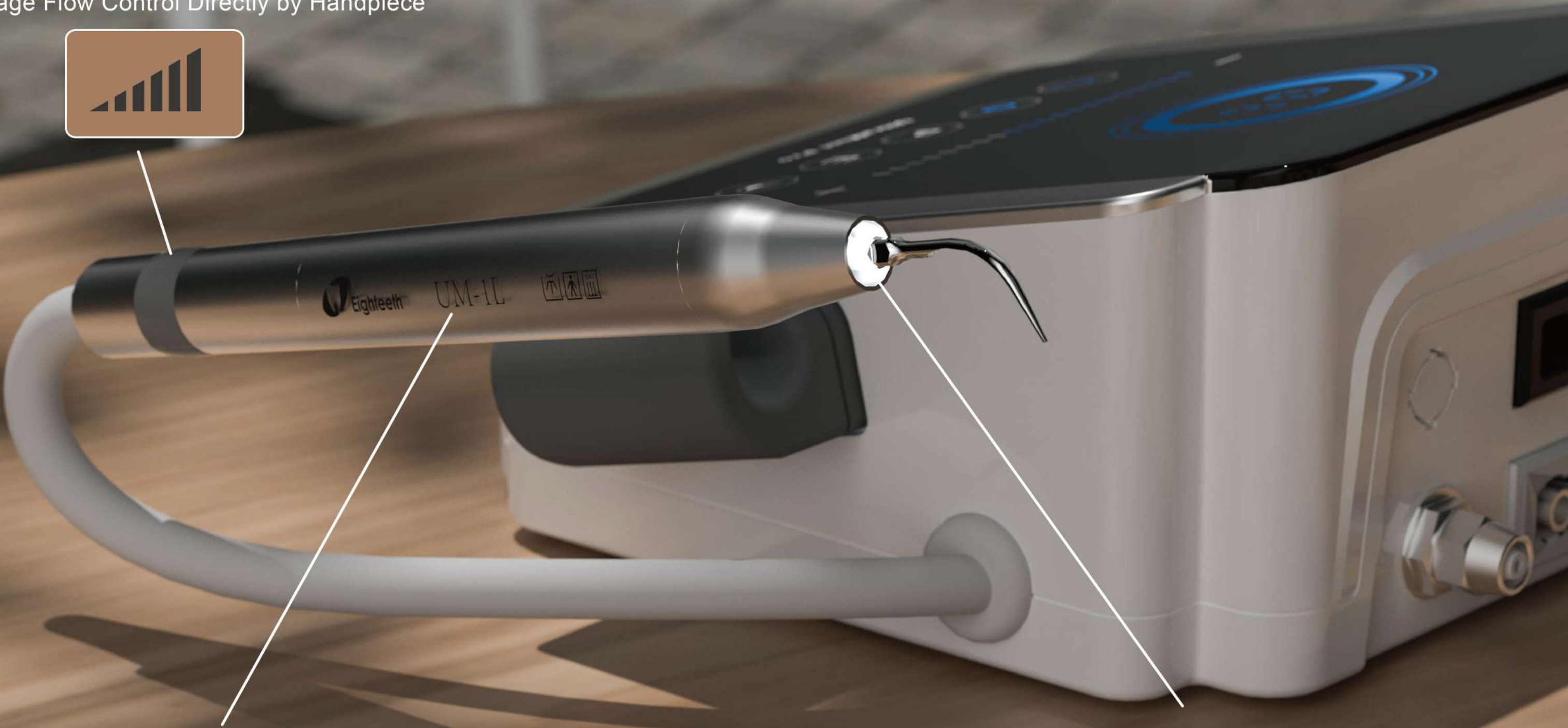

Detachable



LED Handpiece

Available Tips

G1

Used to remove light and medium supragingival calculus and bacterial plaque



G2

Flat edge is used to remove heavy supragingival calculus



G4

Used to remove all supragingival calculus and bacterial plaque



P1

Used to remove subgingival calculus



P3

Used to remove subgingival calculus



E4

Quickly removes obstructions and broken instruments in the mid to upper thirds of large and straight canals



Optional

G5

Used to remove all supragingival calculus and bacterial plaque



P4

Clean the surface of root during periodontal flap surgery



P50L

Used for subgingival scaling, periodontal pocket probing and root planing
Applicable areas: labial proximal surface of upper front teeth, lingual proximal surface of upper front teeth, buccal interproximal in B quadrant, and lingual interproximal in C quadrant



P50R

Used for subgingival scaling, periodontal pocket probing and root planing
Applicable areas: labial proximal surface of upper front teeth, lingual proximal surface of upper front teeth, lingual interproximal in B quadrant



P53L

Used for subgingival scaling, periodontal pocket probing and root planing
Applicable areas: labial proximal surface of upper front teeth, lingual proximal surface of upper front teeth, buccal interproximal in B quadrant and lingual interproximal in C quadrant



P53R

Used for subgingival scaling, periodontal pocket probing and root planing
Applicable areas: labial proximal surface of upper front teeth, lingual proximal surface of upper front teeth, lingual interproximal in B quadrant



P59

Used for subgingival scaling, periodontal pocket probing and root planing
Applicable areas: lingual and lip side of front teeth and lower front teeth, buccal side in A quadrant and maxillofacial side in B quadrant



P52

Used for subgingival scaling, periodontal pocket probing and root planing
Applicable areas: lingual and lip side of front teeth and lower front teeth, buccal side in A quadrant and maxillofacial side in B quadrant

